

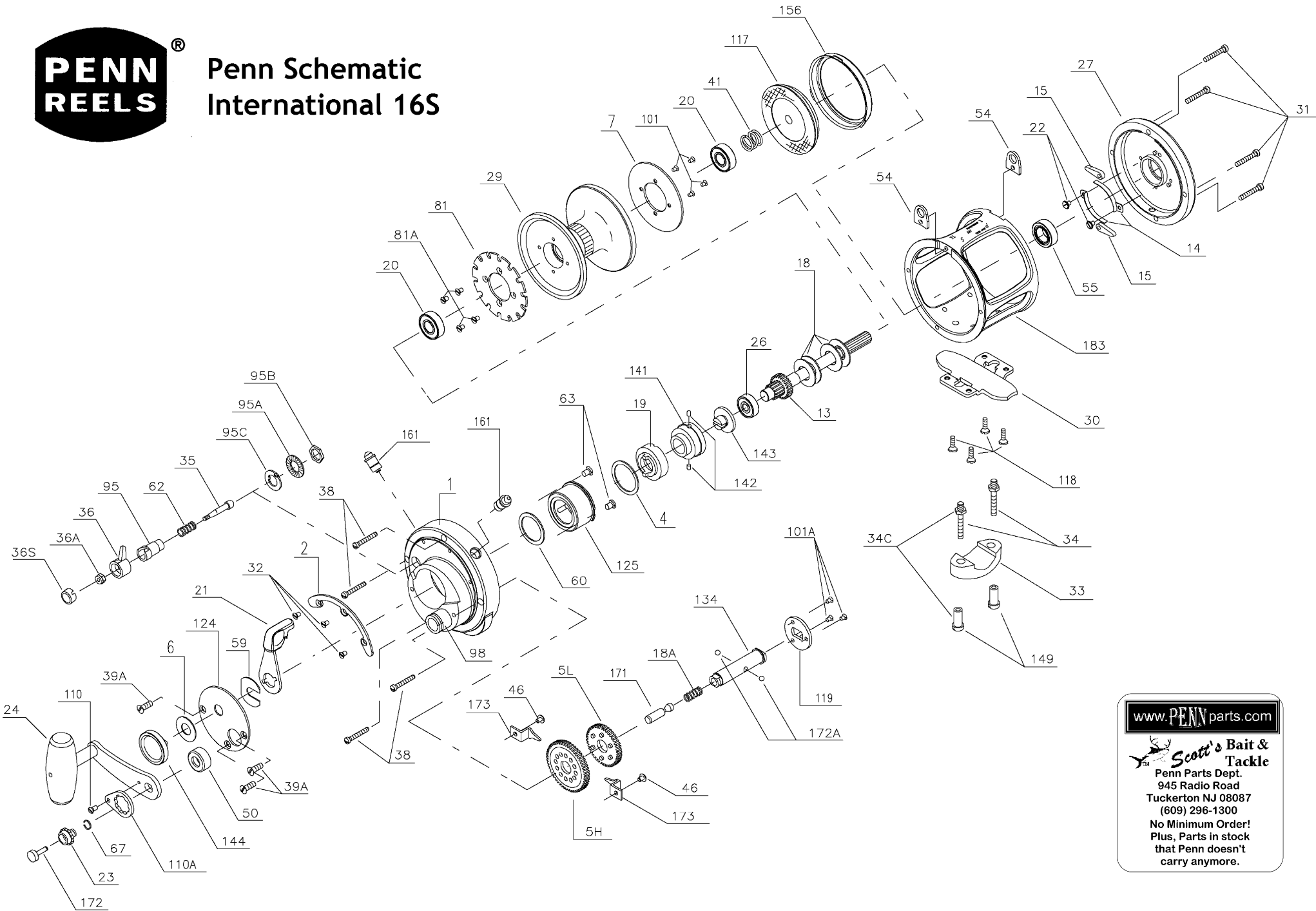

Penn Schematic International 16S



www.PENNparts.com
Scott's Bait & Tackle
Penn Parts Dept.
945 Radio Road
Tuckerton NJ 08087
(609) 296-1300
No Minimum Order!
Plus, Parts in stock
that Penn doesn't
carry anymore.

Penn Reel Parts list for:

Model: 16S

INTERNATIONAL

KEY PART NO NO.	DESCRIPTION	KEY PART NO NO.	DESCRIPTION
1 1-16S	R.S. PLATE ASSEMBLY	59 59-50	SLOTTED WASHER
2 2-16S	QUADRANT RING	60 60-50	BACKING WASHER
4 4-30	CAM THRUST WASHER	62 18-60	CLICK SPRING
5H 5-16HS	MAIN GEAR HIGH SPEED	63 63-349	HOLD DOWN SCREW (2 REQ.)
5L 5-16LS	MAIN GEAR LOW SPEED	67 67-16S	PLUNGER CAP RETAINING RING
6 6-155	SPACER WASHER	69 69-50	LOCATING PIN (2 REQ.)
7 7-16S	METAL DRAG WASHER	69B 69B-50	RETAINING RING (2 REQ.)
13 13-16S	PINION GEAR	81 81-16S	RATCHET
14 14-16S	DOG SPRING (2 REQ.)	81A 101-30	RATCHET SCREW (4 REQ.)
15 15-50	DOG (2 REQ.)	95 95-80	CLICK TONGUE BUSHING
18 18-20	DISC CLUTCH SPRING (4 REQ.)	95A 95A-20	CLICK BUSHING WASHER
18A 18-349	GEAR STUD SPRING	95B 38-710	CLICK BUSHING NUT
19 19-16S	ECCENTRIC CAM	95C 95A-50	CLICK BUSHING NUT
20 20L-704	SPOOL BALL BEARING (2 REQ.)	98 98-16S	BRIDGE BUSHING
21 21-16S	ECCENTRIC LEVER	101 101-30	DRIVE PLATE SCREW (4 REQ.)
22 22-109	DOG SPRING SCREW (2 REQ.)	101A 101-50S	COUPLING PLATE SCREW (3 REQ)
23 23-16S	HANDLE SCREW	110 110-50	HANDLE LOCK SCREW
24 24-16S	HANDLE COMPELTE	110A 110A-16S	HANDLE LOCKING PLATE
26 26-40	BALL BEARING	117 117-16S	DRIVE PLATE W/ DRAG WASHER
27 27-16S	L.S. PLATE	118 118-80	STAND SCREW (4 REQ.)
29 29L-16S	SPOOL	119 119-30S	COUPLING PLATE
30 30-12LT	STAND	124 124-16S	BRIDGE COVER
31 31T-20	R.S. PLATE SCREW (4 REQ.)	125 125-30S	CAM HOUSING
32 110-50	QUADRANT SCREW (3 REQ.)	134 134-16S	GEAR STUD
33 33-113	ROD CLAMP	141 141-16S	CAM FOLLOWER
34 34-114HLW	CLAMP SCREW (2 REQ.)	142 142-50	CAM FOLLOWER PIN (2 REQ.)
34C 34C-114HLW	ROD CLAMP SCREW W/ NUT	143 143-30	ADJUSTING SCREW
35 35-80TN	CLICK TONGUE	144 144-16S	PRESENT KNOB
36 36N-50	CLICK BUTTON	149 149-45	ROD CLAMP NUT (2 REQ.)
36A 36-700	CLICK BUTTON NUT	156 156-16S	DRAG COVER
36S 36S-80ST	CLICK BUTTON CAP	161 161-50	LOCATING PIN BUSHING (2 REQ.)
38 38T-50	R.S. PLATE SCREW (4 REQ.)	162 162-50	LOCATING PIN SPRING (2 REQ.)
39A 39A-80S	BRIDGE COVER SCREW (3 REQ.)	171 171-16S	PLUNGER
41 41-16S	L.S. BEARING SPRING	172 172-16S	PLUNGER CAP
46 46A-704	CAM HOUSING SCREW (2 REQ.)	172A 172A-16S	SHIFTING BALL (2 REQ.)
50 50-16S	GEAR STUD SHEILD	173 173-50S	GEAR RETAINER (2 REQ.)
54 54-16S	HARNESS LUG (2 REQ.)	183 183-16S	TUBE FRAME
55 55-80ST	BALL BEARING		

NOTE: Many of www.pennparts.com schematics include changes that were either made by Penn, or errors found and corrected by our parts dept.

Last update 1/27/05