

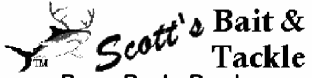

PARTS LIST FOR MODEL 70VS After Serial Number F070001

www.PENNparts.com



Penn Parts Dept.
945 Radio Road
Tuckerton NJ 08087
(609) 296-1300

No Minimum Order!
Plus, Parts in stock
that Penn doesn't
carry anymore.

SBT Ver. 041009

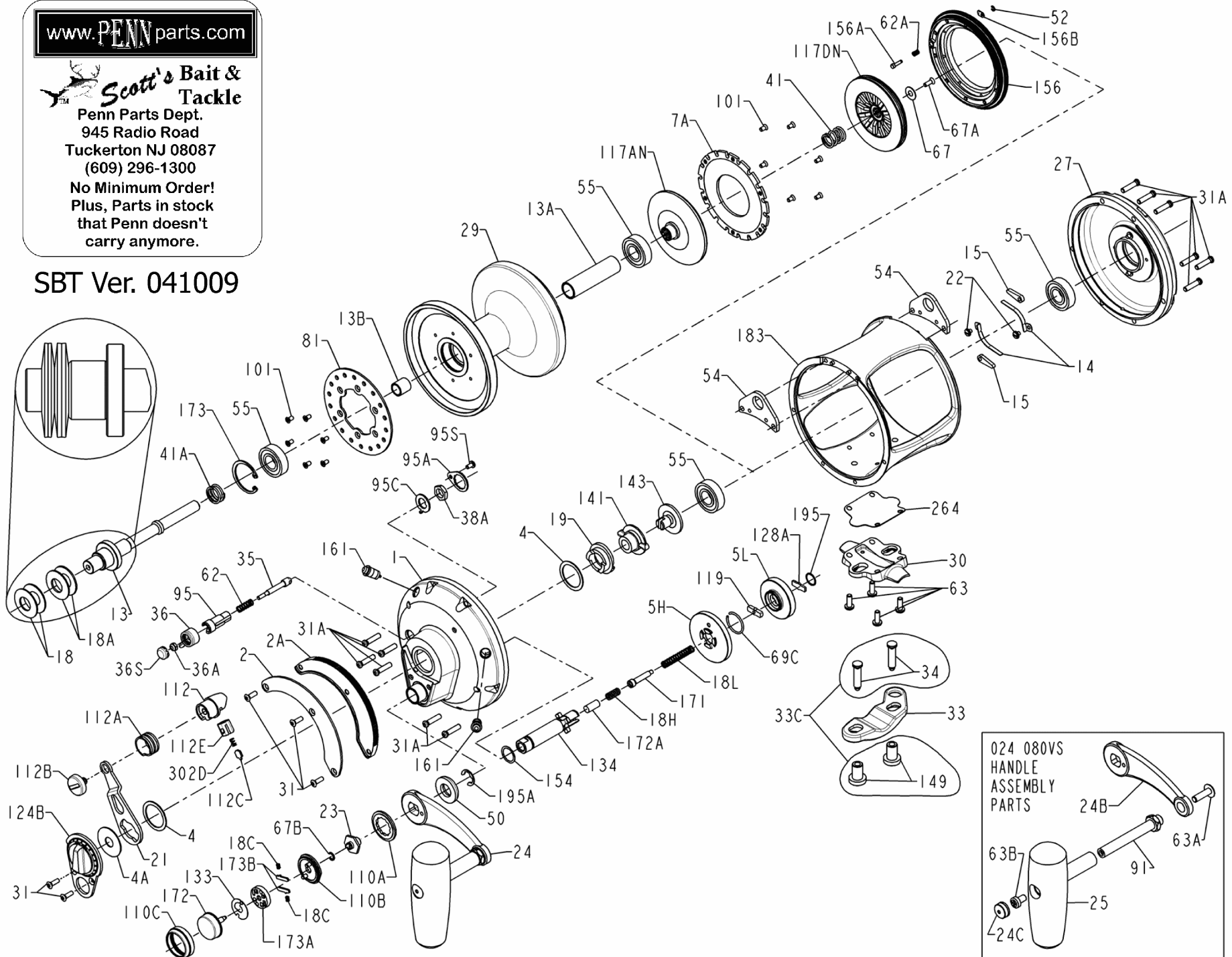

Penn Reel Parts list for Model: 70VS After #F070001

| KEY PART | KEY PART | DESCRIPTION | KEY PART | DESCRIPTION |
|--------------|------------------|------------------------------|------------------|------------------------------------|
| NO NO. | NO NO. | | NO NO. | |
| 1 1-70VS | 67 67-70 | RIGHT SIDE PLATE ASSEMBLY | 67 67-70 | PINION GEAR WASHER |
| 2 2-70 | 67A 67A-70 | QUADRANT RING | 67A 67A-70 | RETAINING SCREW |
| 2A 2A-70VS | 67B 67-30VS | QUADRANT SPACER/RATCHET | 67B 67-30VS | RETAINING C-RING |
| 4 4-70 | 69C 69C-245 | CAM THRUST WASHER (2 REQ.) | 69C 69C-245 | SHIFT RETAINING RING |
| 4A 4A-70 | 81 81-70 | CAM TEFLON WASHER | 81 81-70 | RATCHET |
| 5H 5-70VSHS | 91 91-80VS | MAIN GEAR (HIGH SPEED) | 91 91-80VS | HANDLE KNOB SHAFT |
| 5L 5-70VSL | 95 95-70 | MAIN GEAR (LOW SPEED) | 95 95-70 | CLICK TONGUE BUSHING |
| 7A 7A-50VS | 95A 95B-70 | METAL DRAG WASHER | 95A 95B-70 | CLICK BUSHING WASHER |
| 13 13-70 | 95C 95A-50 | PINION GEAR | 95C 95A-50 | CLICK BUSHING WASHER |
| 13A 13B-70VS | 95S 46A-704 | SPOOL SLEEVE | 95S 46A-704 | RETAINING PLATE SCREW |
| 13B 13B-70 | 101 101-30 | PINION GEAR SLEEVE | 101 101-30 | RATCHET PLATE SCREW (10 REQ.) |
| 14 14-50 | 110A 110A-30VS | DOG SPRING (2 REQ.) | 110A 110A-30VS | HANDLE SCREW LOCKING PLATE |
| 15 15-50 | 110B 110B-30VS | DOG (2 REQ.) | 110B 110B-30VS | SHIFTER BASE PLATE SUB-ASSEMBLY |
| 18 18-80 | 110C 110C-30VS | DISC CLUTCH SPRING (4 REQ.) | 110C 110C-30VS | SHIFT BUTTON RETAINING RING |
| 18A 18-80W | 112 112B-30VS | DISC CLUTCH SPRING (4 REQ.) | 112 112B-30VS | ECCENTRIC KNOB |
| 18C 18C-15KG | 112A 112A-30VS | SHIFT BUTTON SPRING (2 REQ.) | 112A 112A-30VS | ECCENTRIC KNOB SLEEVE |
| 18H 18H-30VS | 112B 112B-70 | SHIFT SPRING (HEAVY) | 112B 112B-70 | ECCENTRIC KNOB SCREW |
| 18L 18L-30VS | 112C 112C-30VS | SHIFT SPRING (LIGHT) | 112C 112C-30VS | ECCENTRIC CLICK PLATE |
| 19 19-70 | 112E 112E-30VS | ECCENTRIC CAM | 112E 112E-30VS | ECCENTRIC CLICK PLATE HOUSING |
| 21 21-70 | 117AN 117AN-70 | ECCENTRIC LEVER | 117AN 117AN-70 | RETAINING PLATE W/ DRAG WASHER |
| 22 22-109 | 117DN 117DN-70VS | DOG SPRING SCREW (2 REQ.) | 117DN 117DN-70VS | DRIVE PLATE W/ DRAG WASHER |
| 23 23-30VS | 119 119-24KG | SHIFT HOUSING SCREW (2 REQ.) | 119 119-24KG | COUPLING PLATE |
| 24 24-80VS | 124B 124L-70 | HANDLE COMPLETE | 124B 124L-70 | BRIDGE COVER ASSEMBLY |
| 24C 24C-80ST | 128A 128A-24KG | HANDLE KNOB CAP | 128A 128A-24KG | SHIFT DRIVE PLATE |
| 25 25-80ST | 133 133-30VS | HANDLE KNOB ASSEMBLY | 133 133-30VS | SHIFTER RETAINING PLATE |
| 27 27-70VS | 134 134-70VS | L.S. PLATE ASSEMBLY | 134 134-70VS | GEAR STUD |
| 29L 29L-70VS | 141 141-70 | SPOOL | 141 141-70 | CAM FOLLOWER |
| 30 30-50VS | 143 143-70 | STAND | 143 143-70 | PRESET SCREW |
| 31 31T-70 | 149 149-70 | SHORT SCREW (5 REQ.) | 149 149-70 | ROD CLAMP NUT (2 REQ.) |
| 31A 31-80VS | 154 154-80 | SIDE PLATE SCREW (12 REQ.) | 154 154-80 | GEAR STUD SHIM |
| 33 33-70 | 156 156N-50VS | ROD CLAMP | 156 156N-50VS | SEALED DRAG COVER ASSEMBLY |
| 34 34-70VS | 156A 156A-30VS | CLAMP SCREW (2 REQ.) | 156A 156A-30VS | LOCK PIN |
| 35 35-70VS | 156B 156B-30VS | CLICK TONGUE | 156B 156B-30VS | LOCK PLATE |
| 36 36N-50 | 161 161C-30VSW | CLICK BUTTON | 161 161C-30VSW | LOCATING PIN ASSEMBLY (2 REQUIRED) |
| 36A 36-700 | 171 171-15KG | CLICK BUTTON NUT | 171 171-15KG | SHIFT PLUNGER |
| 36S 36S-80ST | 172 172-30VS | CLICK BUTTON CAP | 172 172-30VS | SHIFT BUTTON ASSEMBLY |
| 38A 38-710 | 172A 172A-70VS | CLICK BUSHING NUT | 172A 172A-70VS | SPRING SPACER |
| 41 41-50 | 173 173-80VS | DRAG SPRING | 173 173-80VS | RETAINING RING |
| 41A 41-70 | 173A 173A-30VS | BEARING SPRING | 173A 173A-30VS | SHIFTER CATCH HOLDER |
| 50 50-50VS | 173B 173-30VS | SHIELD | 173B 173-30VS | SHIFTER CATCH PLATE (2 REQUIRED) |
| 52 52-910 | 183 183-70VS | RETAINING RING | 183 183-70VS | TUBE FRAME |
| 54 54A-80S | 195 195-24KG | HARNES LUG (2 REQ.) | 195 195-24KG | SPIRAL RETAINING RING |
| 55 55-80 | 195A 195-40 | BALL BEARING (2 REQ.) | 195A 195-40 | RETAINING "E" RING |
| 62 62-50 | 264 264-30VS | CLICK SPRING | 264 264-30VS | STAND GASKET |
| 62A 62-545 | 302D 302D-525MAG | CLICK SPRING | 302D 302D-525MAG | ECCENTRIC CLICK PLATE SPRING |
| 63 63-30T | | STAND SCREWS (4 REQ.) | | |
| 63A 63A-50 | | HANDLE SHAFT SREW | | |
| 63 63-80VS | | HANDLE KNOB SCREW | | |

NOTE: Many of www.pennparts.com schematics include changes that were either made by Penn, or errors found and corrected by our parts dept.

SBT Ver. 041009

(based on Penn's 407N-70vs Rev. 2 -7/7/07)